

## PUMPHEAD REPLACEMENT - SPH, DPH & TPH

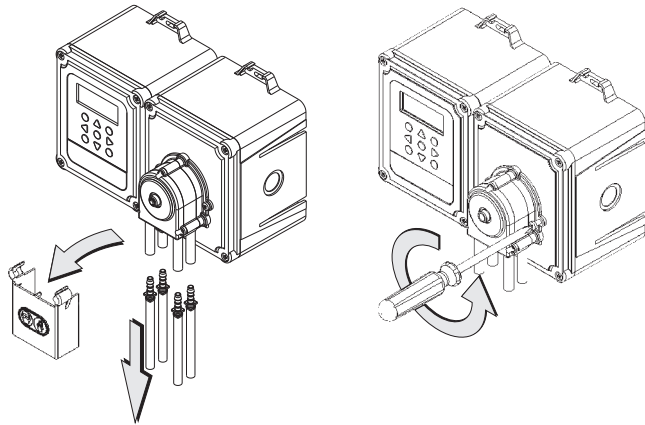

We recommend that Pumpheads are stored in a cool dark place, away from direct sunlight.  
All peristaltic tube material has a limited shelf life, therefore a stock rotation system should be employed.

1



Using appropriate safety equipment, detach the pumphead splash guard and the suction/delivery tubes.  
Using a "Cross Head" screwdriver, remove the two pumphead retaining screws.

2

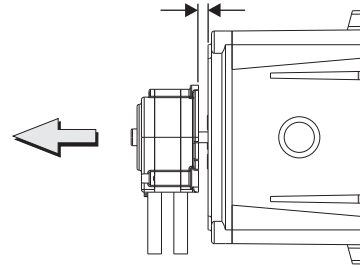

Pull the pumphead a few millimeters away from the enclosure. It may help to rotate the pumphead slightly as it is pulled.

3

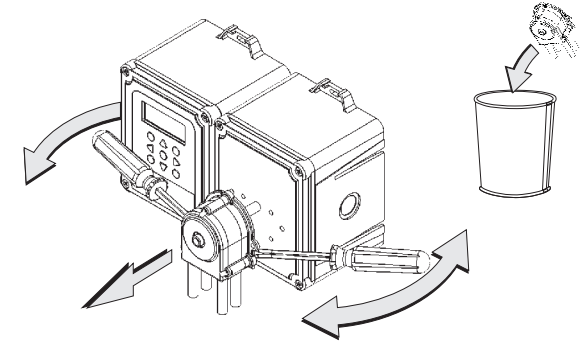

Using two medium sized, flat blade screw drivers, carefully lever off the old pumphead.  
The old pumphead should be safely disposed of.

4

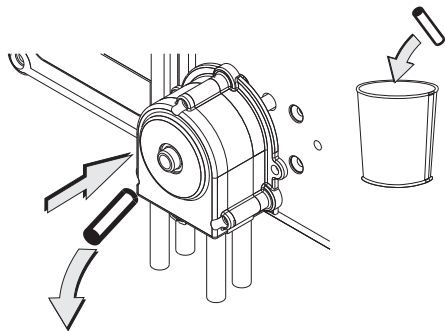

Line the new pumphead up with the motor shaft and push on firmly.  
The centre spindle of the new pumphead will then be ejected.  
This can be discarded.

5

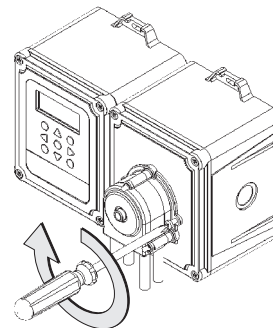

Re-fit the pumphead retaining screws.

6

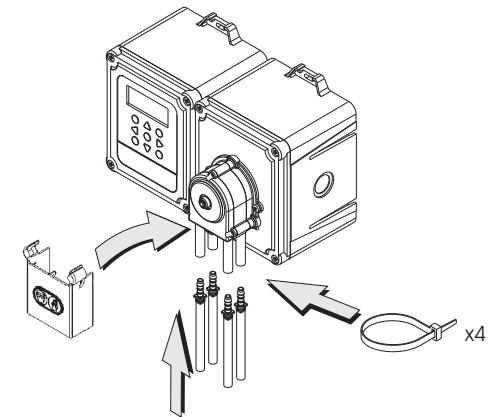

Re-fit the splash guard and the suction/delivery tubes,  
using cable ties to secure and seal the connections.